

HDLPC23

Features In Brief

1. Energy saving exceeding 60%
2. Uniformed light distribution.
3. Original Epistar chips
4. Instant start, no flicking, no humming.
5. DALI/1-10V/DSI Versions available
6. 3 year warranty



CL5 LED downlights are designed to replace the traditional PL downlights commonly seen within offices and communal areas. The solid construction of this unit offers both uniformed light distribution as well as maintenance free operation. The downlight comes prewired with driver and has dimming options for 1-10v/DALI/DSI. Using original Epistar chips this unit is truly a fit and forget solution

PART NUMBER	COLOUR	LUMINOUS FLUX
HDLPC23-PLUS/CIRC or SQ	5000K	2139 lm
HDLPC23-PLUS/CIRC or SQ	4000K	2093 lm
HDLPC23-PLUS/CIRC or SQ	3000K	1886 lm
HDLPC23-PLUS/CIRC/SURF	4000K	2093 lm

Complete Lighting Services Limited

Rooksdown House, Southern Road, Basingstoke, Hants, RG21 3DZ

Tele: 01256 811600 Fax: 01256 811601 email: reception@completelighting.co.uk

DOWNLIGHT PRODUCT FEATURES

23W RANGE			
ITEM	HDLPC23P/5000k	HDLPC23P/4000k	HDLPC23P/3000k
Input Voltage	100~240V	100~240V	100~240v
Power Consumption	23 W	23 W	23 w
Colour	Daylight	Cool White	Warm White
Colour Temperature	5000k	4000k	3000k
Life Time	>50,000 Hour	>50,000 Hour	>50,000 Hour
Operating Temperature	-40°C to + 65°C	-40°C to + 65°C	-40°C to + 65°C
Storage Temperature	-30°C to + 60°C	-30°C to + 60°C	-30°C to + 60°C
Lumen	2139 lm	2092 lm	1886 lm
Certificates	CE, RoHS, FCC, WEEE	CE, RoHS, FCC, WEEE	CE, RoHS, FCC, WEEE
Beam Angle	110°	110°	110°
Outer Dimensions	SEE BELOW	SEE BELOW	SEE BELOW
Cut out Size	200mm	200mm	200mm
CRI	80	80	80
IP Rating	IP44	IP44	IP44

PRODUCT DIMENSIONS



Ø230mm • 23W



Hole size
Ø 200mm

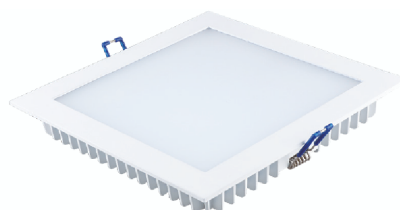
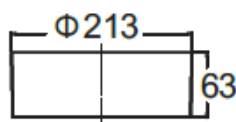

□230X230mm • 23W



Hole size
□ 200x200mm

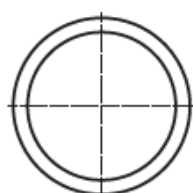

CHROMATICITY DIAGRAM

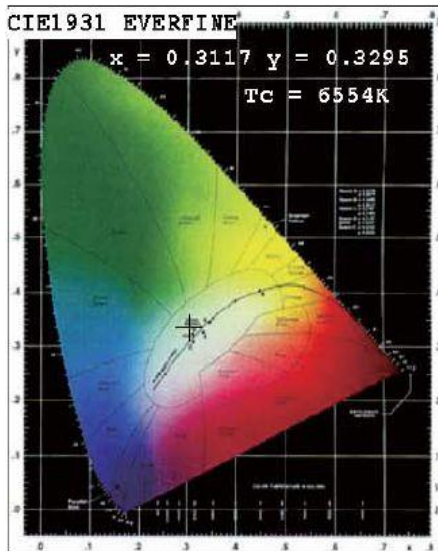

Complete Lighting Services Limited
Rooksdown House, Southern Road, Basingstoke, Hants, RG21 3DZ
Tele: 01256 811600 Fax: 01256 811601 email: reception@completelighting.co.uk

